

DT 1990 PRO MKII

Premium Studio Headphone

Order # 1000303 (black)



FEATURES

- Open design
- Rugged spring steel headband construction
- Circumaural soft ear pads for high wearing comfort
- Headband pad with fontanelle recess for pressure relief
- Single-sided detachable mini XLR cable
- Gold-plated mini stereo jack plug (3.5 mm) & 1/4" adapter (6.35 mm)
- Made in Germany

SUPPLIED ACCESSORIES

- 1 x "Producing" ear pad set, velours, black, with slight bass boost, incl. acoustic disc Order # 1001985
- 1 x "Mixing & Mastering" ear pad set, velours, black, for linear sound, incl. acoustic disc Order # 1001978
- 1 x PRO X straight cable, 3 m Order # 728471
- 1 x PRO X coiled cable, 5 m (stretched) Order # 728489
- 1 x Hard case Order # 717967

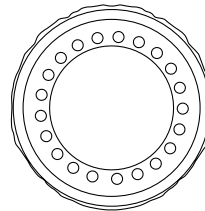

"Producing"

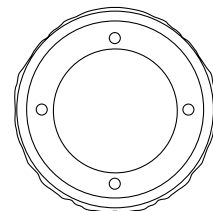

"Mixing & Mastering"



beyerdynamic

DT 1990 PRO MKII

Premium Studio Headphone

Order # 1000303 (black)

DESCRIPTION

The DT 1990 PRO MKII is an open studio headphone for mixing, mastering and editing. The open design creates a very spatial, dynamic and natural sound with a faithful reproduction of the original.

The efficient Tesla.45 drivers ensure a perfect sound with an excellent resolution, spatiality and high output level.

The DT 1990 PRO MKII features a modern design with a simple elegance of all components such as the end pieces, yokes, ear cups and headband. All components can be replaced and ensure a long life of the headphones.

The single-sided mini XLR cable is detachable and can be locked.

The rugged spring steel headband gives the headphones a secure fit and the mechanical reliability required for everyday use.

Soft headband and ear pads contribute to a high level of long-term comfort. Headband and ear pads can be replaced if necessary.

The connection cable is fitted with a gold-plated mini stereo jack plug (3.5 mm) with a 1/4" adapter (6.35 mm) and can be connected to all standard headphone outputs.

The delivery includes a hard case for safe transport or storage.

ACCESSORIES / REPLACEMENT PARTS

Various accessories and replacement parts can be found at: www.beyerdynamic.com

TECHNICAL SPECIFICATIONS

Transducer type	Dynamic
Operating principle	Open
Wearing type	Circumaural
Frequency response	5 - 40,000 Hz
Nominal impedance	30 Ω
Sound pressure level @ 1 mW/500 Hz	94 dB
Sound pressure level @ 1 V/500 Hz	110 dB
T.H.D. @ 1 mW	0.20% @ 100 Hz 0.06% @ 500 Hz 0.08% @ 1 kHz
Highest short-term power handling capacity	100 mW
Highest nominal power handling capacity (continuous operation)	30 mW
Nominal headband pressure	6 \pm 0.5 N
Weight (without cable)	376 g
Length and type of cable	3 m / straight cable or 5 m / coiled cable (stretched), each with 3-pin mini XLR cable connector, detachable, single sided
Connection	Gold-plated mini stereo jack (3.5 mm) & 1/4" adapter (6.35 mm)

(all specifications acc. to EN 60 268-7)



beyerdynamic